

Determining System Specs (Windows 7 and 10)

You'll use Windows' dxdiag program.
Click the start button and type dxdiag in
the search box (blue arrow)

Click the dxdiag.exe result (red arrow)

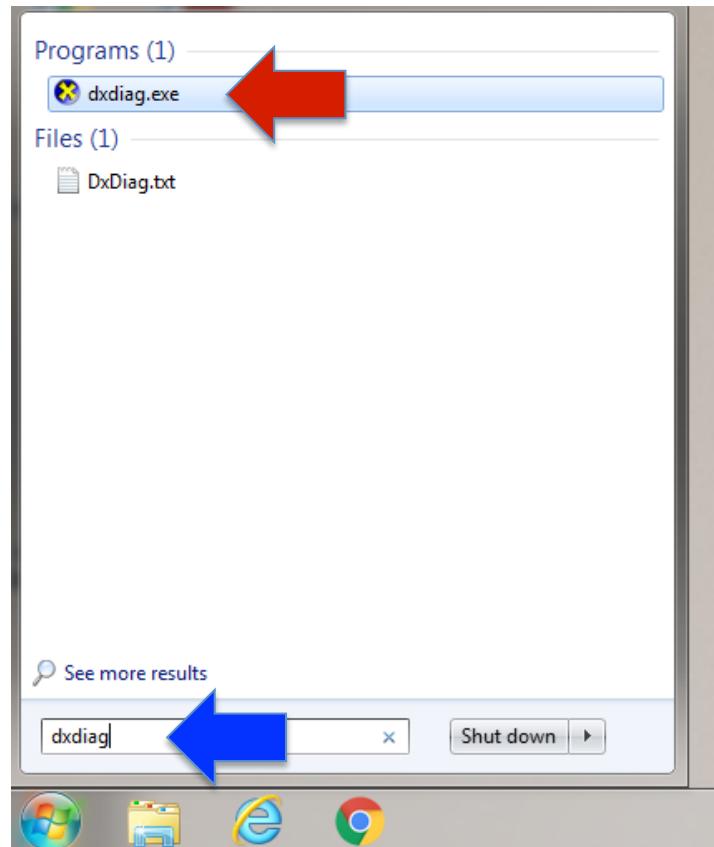

The dxdiag program will start (see figure). Click the "Save All Information" button (green arrow) and save the report to a location you know (eg. Desktop). You can use any filename or accept the default "DxDiag.txt".

Send the DxDiag.txt file
to Cadre (email attachment
is fine)

Note that you can see
your version of windows
and if it's 32 or 64 bit (blue
arrow). You can see your
graphics card information by
selecting the "Display" tab
at the top of the window.

